



WEIDNER CENTER

UNIVERSITY of WISCONSIN-GREEN BAY

TECHNICAL INFORMATION PACKET

August, 2016

Table of Contents

<i>Section</i>	<i>Page</i>
General Information	3
Local Services	4
Directions and Parking	5
Management	6
Loading Area	7
Carpentry	8-9
Lighting	10-12
Sound	13-15
Props	16-18
Wardrobe	19

General Information

Address

Mailing and Shipping Address:

2420 Nicolet Drive
Green Bay, WI 54311-7001

Facility Address:

2450 Weidner Center Drive
Green Bay, WI 54311-7001

Phone and Fax

920-465-2726 Main line
920-465-2619 Fax

Administration

Kate Green
Executive Director
920-465-5108 Phone
greenk@uwgb.edu

Brock Neverman
General Manager
920-465-2759 Phone
nevermab@uwgb.edu

Stephanie Maufort
Program Manager
920-465-5107 Phone
mauforts@uwgb.edu

Technical Services

Paul Heim
Technical Director
920-465-2739 Phone
heimp@uwgb.edu

Ivy Covaciu
Technical Assistant
920-465-2739 Phone
covaciui@uwgb.edu

Drew Arnold
Technical Assistant-Lighting
920-465-2739 Phone

House Management

Elizabeth Anderson
House Manager
920-465-2810 Phone
andersoe@uwgb.edu

Lisa Glinski
Custodian
920-465-5896 Phone
glinski@uwgb.edu

Ticketing

Ticket Star Offices
920-494-3401 Phone
800-895-0071 Toll free

Charles Edinger
Director of Ticket Operations
920-405-1250 Phone
Charles.edinger@pmiwi.com

Local Services

Area Hotels

Days Inn and Suites	(920) 430-7040
Hawthorn Suites	(920) 435-2222
Hyatt on Main	(920) 432-4555
Radisson Inn	(920) 494-7300
Country Inn & Suites	(920) 288-0101

Taxi Services

Astro Shuttle	(920) 499-9199
American Shuttle	(920) 713-4521
1 st Choice Shuttle	(920) 471-6061
Tundra Valley Taxi LLC	(920) 713-7433

Handicapped Transportation

Medi-Vans	(920) 435-5505
-----------	----------------

Restaurants

A list of area restaurants and assorted menus is available upon request.

http://www.greenbay.com/visit_us/dining/

<http://www.travelwisconsin.com/local-visitor-information-centers/greater-green-bay-convention-visitors-bureau-192659#/Dining?NearByItems.CurrentPage=1&AssignedItems.CurrentPage=1>

Laundry

Dry Cleaners:	Laundromat:
Royal Cleaners 2201 University Ave. (920) 465-1096 Phone	Corner Coin Laundry 433 North Irwin Ave. (920) 437-3417 Phone

Emergency Numbers

FIRE	9-911	Non-emergency	(920) 465-2300	(Campus Public Safety must be contacted for all emergencies)
POLICE	9-911	Non-emergency	(920) 465-2300	
AMBULANCE	9-911	Non-emergency	(920) 465-2300	

Hospitals

St. Vincent Hospital	(920) 433-0111
Bellin Health	(920) 433-3500
Aurora Bay Care Medical Center	(920) 288-4040
Prevea Urgent Care	(920) 496-4700

Directions and Parking

Travel Directions

From the South via US Highway 41:

Take exit #165 for Hwy 172 East. Continue East to I-43 North. Continue North to exit #185 for Hwy 54/57 North. Keep right at the fork and Merge onto Hwy 54/57 North. Take the first exit for University Ave/Nicolet Dr. Keep right at the fork and merge onto Nicolet Dr. North. Turn right at Main Entrance Drive.

From the South via I-43:

Take exit #185 for Hwy 54/57 North. Keep right at the fork and Merge onto Hwy 54/57 North. Take the first exit for University Ave/Nicolet Dr. Keep right at the fork and merge onto Nicolet Dr. North. Turn right at Main Entrance Drive.

From the North via US Highway 41:

Take exit #171 for I-43 South. Continue south to exit #185 for Hwy 54/57. Keep left at the fork and merge onto Hwy 54/57 North. Take the first exit for University Ave/Nicolet Dr. Keep right at the fork and merge onto Nicolet Dr. North. Turn right at Main Entrance Drive.

From the North via I-43:

Take exit #185 for Hwy 54/57. Keep left at the fork and merge onto Hwy 54/57 North. Take the first exit for University Ave/Nicolet Dr. Keep right at the fork and merge onto Nicolet Dr. North. Turn right at Main Entrance Drive.

From the West via Highway 54 OR Highway 29/32:

Take ramp #168 (from Hwy 54) or #169 (from Hwy 29/32) to US Highway 41 North. Continue north to exit #171 for I-43 South. Continue south to exit #185 for Hwy 54/57. Keep left at the fork and merge onto Hwy 54/57 North. Take the first exit for University Ave/Nicolet Dr. Keep right at the fork and merge onto Nicolet Dr. North. Turn right at Main Entrance Drive.

Parking

The Weidner Center has ample, well lit parking in 3 adjacent lots on the Northwest side of the facility. Parking permits are required from 7AM until 7PM, Monday through Friday unless arrangements are made in advance with the venue.

Time Zone

The Weidner Center is located in the Central Time Zone (-6 UTC) and Daylight Savings Time is observed.

Management

Production Room

One office is available. It is located on stage level. It is equipped with audio/page monitors and can be equipped with video monitors. Telephones and LAN can be located in the office and several other spaces. Please call the Technical Director to discuss your needs.

Green Room

Located stage left and equipped with page monitor, audio & video stage monitors, 15' x 19'

Stage Manager's Console

Located DSL

Rehearsal Rooms

The Weidner Center has a recital hall, 45' x 54' (13.7m x 16.5m) with a hard wood floor and a rehearsal room, 34' x 34' (10.4m x 10.4m) with a sprung floor. These rooms are regularly scheduled for other uses. Please check with the Production Manager for availability.

Crews

The Weidner Center is a non-union house. Crews are predominately trained students and community members with I.A.T.S.E. Hands called as needed. All crews, including students, are scheduled for the duration of the call.

A Weidner Center Technical Staff member must be present at all times when the facility is in use.

Handicapped Access

The Weidner Center was designed to be fully accessible for people with physical disabilities and is in compliance with 2012 ADA regulations. All levels are served by elevators.

The Weidner Center is equipped with an infrared hearing enhancement system.

Policies

Smoking is not permitted anywhere in the building.

No eating or drinking in the house or control booths.

Persons under the influence of alcohol or drugs will not be permitted to work back stage.

Damages to the premises, equipment or properties of the Weidner Center caused by a company's staff will be paid for by the company.

Lagging, screwing or nailing into the stage floor is allowed, provided the pre-drill process is followed. Please consult with Technical Director for additional information.

Loading Area

Dimensions

The loading dock is located on stage level, directly off stage left.

The dock has three doors

Two @ 7'-10 1/2" x 9'-10 1/2" (2.4m x 3m)

One @ 8'-5" x 9'-10 1/2" (2.7m x 3m).

Each is equipped with a leveler to accommodate different truck heights down to 3'-1" (.94m). Level height is 4'-2" (1.3m).

The loading area is 3,600 sq. ft. in an L shape. Access to the stage is either through a 20' x 28' (6.1m x 8.5m) opening stage left or through a 14' x 14' (4.3m x 4.3m) overhead door up center.

Access to the dressing rooms is by stairs or by elevator. The elevator is 8'-7" x 5'-1" (2.6m x 1.6m) with a 4'-0" x 7'-0" (1.23m x 2.13m) door.

The acoustical shell and personnel lifts are stored in the loading area.

Map

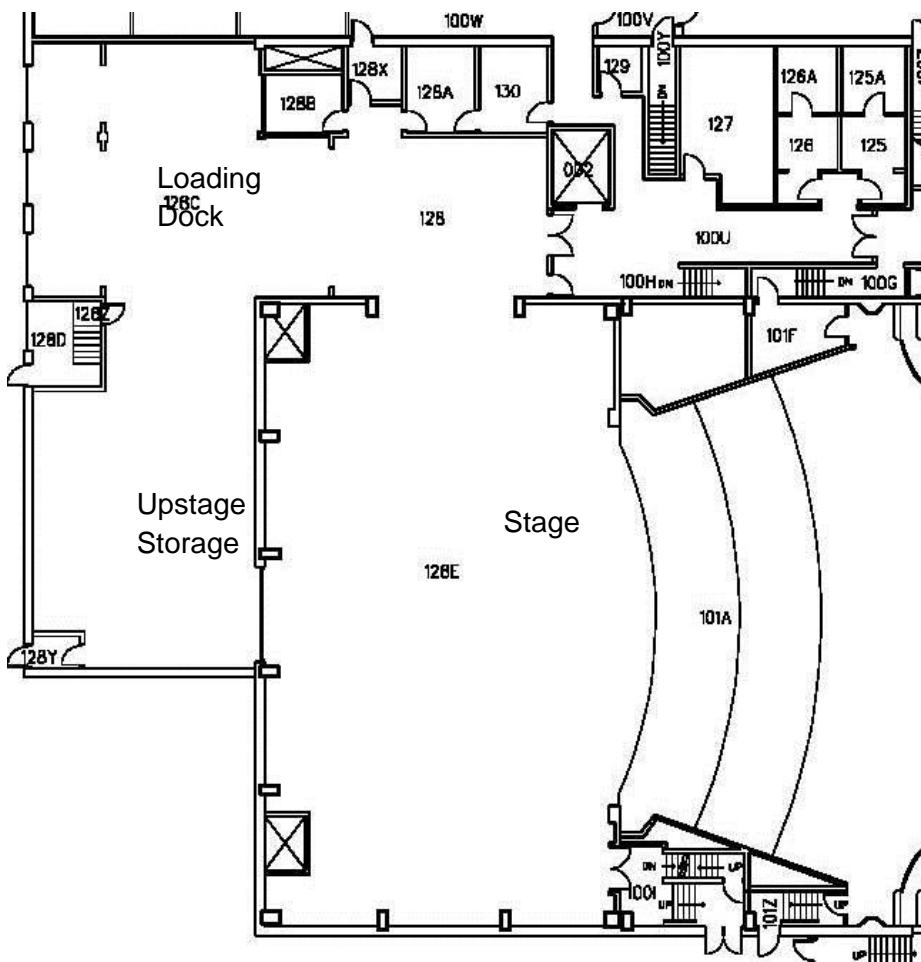

Carpentry

Seating

Orchestra (with pit seating in place)	1221
Orchestra (with pit seating removed)	1025
Orchestra (with one lift in place)	1143
Mezzanine	348
Balcony	452
Total	2021

Stage Dimensions

Proscenium:	Width	54'-4" (16.56m)
	Height	30'-0" (9.14m)
	Depth	48'-0" (14.63m)

Wing Space:	Stage right	13'-6" (4.12m)
	Stage left	16'-6" (5.03m)

Grid Height: 82'-9" (25.22m)

Orchestra Pit: 20'-0" x 60'-0" (6.1m x 18.23m) or 32'-0" x 60'-0" (9.75m x 18.23m) maximum depth-14'-6" (4.42m)

Stage Height: 3'-2" (.97m)

Stage Floor

Material-1/4" hardboard (Fibersin), Subfloor-2 layers of 3/4" plywood; 2 x 4 sleepers (16" O.C.) on resilient pads, Color- black, Condition- good

House Draperies

House Curtain: Burgundy color, manual fly only, does not travel. Operating line located SR.

	<i>QTY</i>	<i>MATERIAL</i>	<i>W x H</i>
Legs:	6	Black velour, no fullness	10' x 32' (3.05m x 9.75m)
Borders:	6	Black velour, no fullness	62' x 10' (18.9m x 3.05m)
	2	Black velour, no fullness	62' x 15' (18.9m x 4.62m)
Full Stage:	2	Black velour, no fullness	62' x 30' (18.9m x 9.14m)
Black Traveler:	1	Black velour, full	62' x 30' (18.9m x 9.14m)
Scrims:	1	Black sharkstooth	62' x 35' (18.9m x 10.7m)
	1	White sharkstooth	62' x 35' (18.9m x 10.7m)
Cyclorama:	1	Seamless muslin	62' x 32' (18.9m x 9.75m)
American Flag:	1	Nylon	30' x 20' (9.14m x 6.09m)

Line Set Data

Line Plot:	Available upon request
Working Height:	High trim 80'-6" (24.54m), low trim 5'-0" (1.52m)
Battens:	69 1-1/2" Schedule 40 single batten, 63'-0" (19.2m) Long. 17 1-1/2" Schedule 40 truss batten, 63'-0" (19.2m) Long
Type:	Single purchase. Two lock rails are available (SR floor and SR Midrail). Line sets 4 and 17 are reserved for acoustical shells. Line sets 70-86 are operated blind behind HVAC duct.
Arbor Capacity:	1200 lbs. (544 kg)
Available Weight:	80,000 lbs. (36,400 kg) in 14 lb. (6.4 kg) and 28 lb. (12.8 kg) sizes.
Loading Gallery:	Stage right
Pin Rails:	Stage right and stage left, 39'9" top rail height from stage floor.

Support Areas

Crossover:	Located under the stage through the dressing room hallway. The stage is deep enough that many sets will allow room upstage for a cross over. Distance between the furthest upstage line set and the upstage wall is 27" with four support columns reducing that width to 5".
Access:	The lobby and Front of House are accessible from stage left only. Access to the seating area from the stage is possible if the orchestra pit is not in use.
Shop Area:	There is no scene shop on location. If major work is needed, pre-arrangements can be made to use the Theater Department scene shop which is fully equipped for wood construction. This shop is located across the street from the Weidner Center. Additional charges for use of University's scene shop do apply and is subject to availability. Please consult with General Manager for additional information.
Storage:	The loading area may be used for storage.

Personnel Lifts

1	JLG AMS-24AC	24' (7.3 m)
1	JLG AMA-36DC	36' (11 m)
1	U Drive 25, Genie AWP-20	25' (7.6 m)

Lighting

Power

6 @ 400 amp, 3 phase, 4 wire, 120/208v	USL	Cam-Lock
1 @ 200 amp, 3 phase, 4 wire, 120/208v	USL	Tail Connection
1 @ 100 amp, 3 phase, 4 wire, 120/208v	DSR	Tail Connection
1 @ 100 amp, 3 phase, 4 wire, 120/208v	Grid	Tail Connection

Dimmers

360	20A
12	50A

NOTE: Facility is wired dimmer per circuit

DMX Input

5 pin DMX input points are located in the Control Booth, DSL, DSR, Near Boom Left and Right, Far Boom Left and Right, Mezzanine Rail Left and Right, Near Catwalk and Far Catwalk.

Control Board

ETC ion

Fader Wing
Dual touch screen Monitors

ETC Insight 3, Software Version 3.1

ETC Remote Focus Unit
ETC Radio Remote Focus Unit
ETC Remote Video Interface

ETC SmartFade 12/24

Houselights

ETC Unison control, preset levels are adjustable, fade times are not. Controlled from lighting booth, Stage Manager's Panel (Stage Left), or lighting console.

Circuits

<i>Circuits</i>	<i>Location</i>	<i>Circuits</i>	<i>Location</i>
1-4	Spot booth	125-350	Over stage drop boxes
5-34	Far catwalk	351-354	DSR, DSL, USR, USL
35-66	Near catwalk	355-357	USL
67-82	Balcony rail	358-360	USC
83-93	HR far boom	361-363	USR
94-104	HL far boom	364-366	Pit SL
105-114	HR near boom	367-369	Pit CS
115-124	HL near boom	370-372	Pit SR

The following circuits are wired with 60A stage pin connectors:

3,4,17,22,49,52,70,74,78,82,93,104

Front of House Positions

Near Catwalk	60' (18.3m) throw, 50 degrees to plaster line
Far Catwalk	92' (28m) throw, 40 degrees to plaster line
Balcony Rail	110' (33.5m) throw, 10 degrees to plaster line
Near Box Boom	Down stage side of proscenium
Far Box Boom	37' (11.3m) throw, 45 degrees to center line

Equipment Inventory

Lighting Instruments

276	Source 4 Single Clutch Body	
90	19° Lens Tubes	6.25" Frame
80	26° Lens Tubes	6.25" Frame
60	36° Lens Tubes	6.25" Frame
10	50° Lens Tubes	6.25" Frame
60	10° Lens Tubes	12" Frame
2	19° Enhanced Definition Lens Tubes	6.25" Frame
2	26° Enhanced Definition Lens Tubes	6.25" Frame
2	36° Enhanced Definition Lens Tubes	6.25" Frame

NOTE: Source 4 fixtures are lamped with HPL-750/115X lamps. HPL-375/115X and HPL-575/115X lamps are available.

48	Strand 8" Fresnelite	Model 3480	10" Frame	1000W Lamp
2	Strand 6" Fresnelite	Model 3380	7.5" Frame	750W Lamp
48	Strand PAR64	Model 4757	10" (25.4cm) Frame	
90	Altman PAR64	Model PAR64	10" (25.4cm) Frame	

PAR lamps available: VN5P, NSP, MFL, WFL

6	Strand Iris Cyc, 4 Cell	Model 5914	15 1/2" x 12" Frame	
32	Strand Orion Ground Row	Model 26011	10" x 11 1/2" Frame	
6	PAR64 ACL Bar, 4 Light		10" (25.4cm) Frame	250W Lamp
2	Thomas 8 Light			2400W Total

Followspots

4	Strong Super Trouper Long Throw,	6 Frame	2000W Xenon
2	Lycian Midget	7 Frame	2000W Quartz

Hardware

60	Source 4 Pattern Holder, Steel
35	6" Top Hats
18	8" Top Hats
52	10" Top Hats
30	ETC S4 Donuts
20	ETC S4 10° Donuts
16	ETC Barrel (gel frame) extenders
24	8" Barndoor, 4-Leaf
100	14" Side arm, Single Tee
100	24" Side arm, Double Tee

- 22 Floor bases, single fixture
- 6 Floor bases, 4 fixtures
- 12 18' Booms
- 6 8' Booms
- 10 Boom Bases
- 8 Scenery Guards

NOTE: The Weidner Center currently stocks Roscolux color.

Cable

- 12/3 SO with 20 amp, 3-pin stage connectors
- 10 @ 100' (30.5m)
- 20 @ 50' (15.2m)
- 90 @ 25' (7.6m)
- 80 @ 10' (3.1m)
- 40 @ 5' (1.5m)
- 60 Twofers
- 16 Edison to Stage Pin adapters
- 6 Stage Pin to Edison adapters
- 6 60 amp to 20 amp twofer adapters, fused
- 4 Union Connector breaker boxes, 60 amp to three 20 amp

Film, Video and Projection Equipment

- 2 35mm slide projector, Navitar 750DM xenon
- 2 35mm slide projector, Kodak Ektagraphic III AMT, 300w Slide projector
- Lenses: 2 Buhl 12.4" to 18.6" (315-472mm) f3.8 zoom
- 2 Schneider 85-210mm f3.9 zoom
- 2 Kodak 75-120mm f3.5 zoom
- 1 Overhead projector, Elmo HP-L355
- 1 16mm film projector, Eiki EX-9100, 2000w xenon 6000' (1830m) reel capacity
- 1 S-VHS Hi-Fi VCR, Panasonic AG-1970
- 1 DVD / VCR, Panasonic AG-VP310
- 1 Tote Vision LCD-841D Dual monitor
- 1 Extron IN 1508 Scaling Presentation Switcher
- 1 Denon DN-V210 Professional DVD Player
- 1 Proxima 9260+ Desktop projector
- 1 Panasonic PT-DW6300 WXGA Projector
- 1 Portable screen, 70" x 70" (178cm x 178cm) matte white
- 1 Portable screen, 84" x 84" (213cm x 213cm) matte white
- 1 Rear projection screen 20' x 20' (6.1m x 6.1m) gray

Additional film, video and projection equipment is available through various vendors. Please contact the Technical Services department for more information.

Effects

- 1 High End Systems F-100 Fog Generator with DMX remote
- 1 Rosco Laboratories Chiller Module
- 1 Look Solutions Unique 2 Haze Generator with DMX input
- 1 City Theatrical AquaFog 3300
- 2 Diversitronics S4 Strobe Module with DMX input
- 2 Diversitronics Luma-Power Super Strobe, Model 50
- 2 Rosco Laboratories ImagePro

Audio

Power

100 amp 3 phase, 120/208v, Sound booth on shielded isolation transformer

100 amp 3 phase, 120/208v, DSL isolated ground

20 amp, 120v circuits, 3 on stage, 1 in pit, 1 at house mix, 2 in sound booth on shielded isolation transformer

Wiring

10 mic + 2 speaker jacks per panel, 1 each located DSR, DSL, USR, USL, Pit

4 mic jacks in 1st catwalk

2 speaker jacks in 2nd catwalk

2 speaker jacks in back of balcony

1 Whirlwind 48x8 W4 MASS with passive split & breakout

4 Whirlwind drop box/mic splitter 9 input
2 @ 75', 2 @ 50', 2 @ 25', 2 @ 50' extensions

Mic cable

25 @ 10', 25 @ 20', 30 @ 30', 10 @ 50'

Monitor cable

6 @ 2', 8 @ 10', 4 @ 25', 8 @ 50'

Control Locations

Control booth at the back of the orchestra level, 100' from stage

Concert House mix in the center of the orchestra level, 75' from stage

8' 0" x 8' 0" level area.

150' snake needed to reach house mix from DL or DR

Broadway House mix house left at rear of orchestra level, 96' from stage

14' 0" x 9' 0" level platform

250' snake needed to reach Broadway mix from DL

300' snake needed to reach Broadway mix from DR

NOTE: The Technical Director must be informed at least 3 weeks in advance if Broadway House mix is to be used

Monitor/Paging System

The system can page all dressing rooms and production areas from stage left, booth and House Manager office.

Production Communications

4 channel Clear-Com system to all production areas

4 telex wireless

12 belt packs, single channel

4 belt packs, 2 channels

8 double muff headsets

11 single muff headsets

1 hand set

Equipment Inventory

Mixing Consoles

1 Berringer X32
1 Soundcraft Venue Theater, 40 x 8 x 2 with 10 x 8 matrix
1 Yamaha O1V
1 Yamaha 01V-96
1 Mackie 1604 v1z
1 Midas Venice 240

House Process 4x BSS SoundWeb 9088

Fixed Speakers

Side stacks: 1 EAW KF528 sub - Crown Macro-Tech 5000VZ
1 EAW KF250 sub - Crown Macro-Tech 5000VZ
1 EAW KF650 - Crown MT602 (mid & hi) Crown MT2402 (low) 3 way
1 EAW KF695 - Crown MT602 (mid & hi) Crown MT2402 (low) 3 way

Center array: 3 EAW KF300P - Crown MT602 (hi) Crown MT2402 (low) 2 way
2 EAW KF850 - Crown MT602 (mid & hi) Crown MT2402 (low) 3 way

Front fills: 6 EAW JF80 - Crown MT2402 passive two-way

Rear array: 3 EAW KF300P - Crown MT2402 passive two-way

Under balcony: 20 JBL 8140HT ceiling mounted, delay speakers

Portable Speakers

2 Eastern Acoustic Works FR253HR
4 Eastern Acoustic Works SM202H
2 JBL MR805 15" two-way
2 JBL MR802 12" two-way

Microphones

10 Shure SM57
10 Shure SM58
4 Shure Beta58a
6 Shure SM81
4 Sennheiser MD431
8 Sennheiser MD421
4 Sennheiser MKE4032
9 Crown PCC-160
1 Crown SASS
2 AKG CK-5 or CK-9
1 Beyer M500
5 Neumann KM 140 (2 AK 30 capsules available)
6 Sony ECM-66
2 EV RE-27
6 Countryman DT85 active
6 Whirlwind Director passive

Microphone Stands

10	round base straight stands, silver
6	round base straight stands, black
4	triangle base tall booms, silver
11	tripod base tall booms, black
7	tripod base short booms, black
3	table top straight stands, silver
2	goosenecks

Playback

1	MD	Sony MDS-E11
1	MD	Tascam MD301
2	DAT	Panasonic SV-3700
1	DAT	Panasonic SV-3800
1	CD-R	Tascam CDRW750 CD Recorder
1	CD	Tascam CD301
1	CD / iPod	Tascam 200iB
2	Cassette	Tascam 112B
1	CD / Cass	Tascam CDA700

Signal Processors

1	Klark-Teknik DN504	4ch compressor
1	Symetrix 525	dual gate compressor/limiter
1	Klark-Teknik DN500	compressor/limiter/expander
1	Yamaha SPX-900	Multi effects processor
3	Yamaha SPX-990	Multi effects processor
1	Eventide H-3000SE	ultra harmonizer
4	Rane ME60	graphic equalizer
2	Klark-Teknik DN360B	graphic equalizer

Amplifiers

4	Crest FA901 amplifiers (2 channel) 280w (EIA)
---	---

Cable

Appropriate patch and insert cables available for all Playback and Processing gear

Hearing Assist System

The Center is equipped with an FM system for the hearing impaired.

Props

Orchestra Pit

2 lifts-12' x 60' each (3.66m x 18.23m)

Each lift can stop any distance from stage level to a maximum depth of 14'-6" (4.42m)

Additional 8' (2.44m) under the lip of the stage at a depth of 9'-6" (2.9m)

The pit is equipped with Snap Trap acoustical sound traps for improved acoustics.

NOTE: When lifts are down for an orchestra pit, there is no direct access from the stage to the house.

Music

Chairs

152 Musician chairs, black
10 String bassist stools, adjustable height, gray
8 Cellist chairs, black

Stands

80 Regular Wenger music stands
8 Double reed stands

Stand Lights

40 Stand lights

Sound Shields

6 Adjustable height personal sound shields

Conductor Equipment

1 Conductor's podium
1 Conductor's music stand

Pianos

1 - 9'-6" Bosendorfer Imperial Grand
1 - 9' Steinway Concert Grand
1 - 7' Mason-Hamlin Grand
1 - Mason-Hamlin upright
1 - Yamaha upright
1 - Opus 3702 Casavant pipe organ

Orchestra Shell

Custom designed, complete enclosure

Platforms

The Weidner Center uses Wenger Versalite 3000 risers with modular legs. Risers can be locked together. Skirting and toe rails are available for all risers.

Lids

24pcs - 4' x 8' 2pcs - 4' x 6' 8pcs - 4' x 4'

NOTE: 4'x4' sections require 4 legs each, 4'x6' and 4'x8' sections require 6 legs each

Legs

100pcs - 8"
126pcs - 16"
118pcs - 24"
50pcs - 32"
30pcs-adjustable 22" to 39"

Stair Units

Rolling, with railings
2pcs - 2 step 2pcs - 3 step 2pcs - 4 step

Stationary, no railings
2pcs - 4 step 2pcs - 4 step counter raked 2pcs-5 step, 48" wide 2pcs-5step, 36" wide

Ramps

2 ramps are available, carpeted with railings. Total run of 14' 1" (4.29 m) with a rise of 38" (.96 m)

Choral Risers

Standing Risers

10 pcs - 4 tier with railings

NOTE: Risers can be in either a straight or curved formation

Seated Risers

3' x 8' sections
7 pcs - 8" 7 pcs - 16" 7 pcs - 24" 7 pcs - 32"

Corner sections
4 pcs - 8" 4 pcs - 16" 4 pcs - 24" 8 pcs - 32"
(2 pieces combine to form 1 corner section for a total of 4 corners)

Dance Floor

Harlequin Studio—black - 9 rolls @ 4'-11" x 59' (1.5m x 18m)

Lecterns

2 Custom oak lecterns

Wardrobe

Dressing Rooms

#-STYLE	CAPACITY	LOCATION	SIZE
2-Star	2	Stage left	8'-6" x 8'-6"
4-Principle	2	Basement	10' x 14'-6"
1-Principle	3	Basement	10' x 17'
2-Chorus	20	Basement	14'-6" x 33'
1-Musician	6	Basement	11' x 11'
1-Musician	8	Basement	12' x 13'

All dressing rooms have toilets and sinks. All rooms have make-up mirrors, counters and costume racks. Audio and video stage monitors are available in all dressing rooms. All, except the musicians' rooms, have showers.

Wardrobe Area

2 rooms located in the basement dressing room hallway. Accessible by elevator.

Large Wardrobe:

47' x 21' with separate 9' x 11' laundry room containing 2 top loading washers* and 2 front loading electric dryers

Small Wardrobe:

10' x 11' containing 2 top loading washers* and 2 front loading electric dryers

NOTE: Companies must provide their own detergent as we have none in stock.

Equipment

Irons	2 Sussmann industrial
Ironing Boards	2 portable
Steamers	3 Industrial Jiffy steamer
Rolling racks	5 tall
	4 short
Hanging racks	4 in small wardrobe
	1 in each dressing room
Sewing machine	1 Bernett

Quick Change Booths

Pipe and drape is available to construct quick change areas.

8	Floor bases
8	Upright poles, adjustable 7' -12'
8	Horizontal poles, adjustable 6' - 10'
25	Black velour panels, 117"h x 52"w

Please contact the Technical Director for additional information

Floor Plans, Centerline Section, Lineset Schedule, Circuit Chart or Seating Chart